

Models

50-ALM, 50-ALMST, 50-ALMAA,
50-ALMSTAA, 50ALMSTHAA,
50-ALMSTH & 50-ALM-2J



AUDIO/VISUAL REMOTE ALARMS

Manual No. ALRM001
(Rev 7 April 2005)

Operating Manual

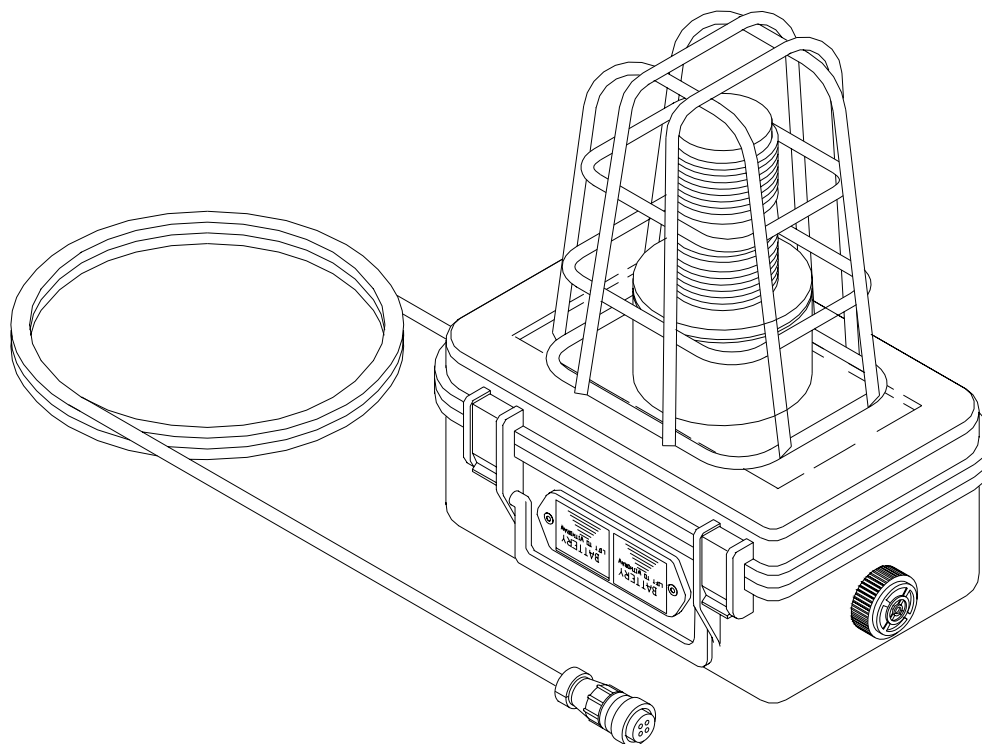

AIRSYSTEMS INTERNATIONAL, INC.

829 Juniper Crescent, Chesapeake, Va. , 23320

Telephone (757) 424-3967

Toll Free 1-800-866-8100

Fax No. (757) 424-5348

<http://www.airsystems.com>

e-mail: sales@airsystems.com



Air Systems International, Inc.
Registered to ISO 9001
Certificate No. A5033

Printed in U.S.A
©Copyright Air Systems International, Inc. 2005. All Rights Reserved.

OVERVIEW

These alarm units have been designed to provide a remote alarm capability for many of Air Systems' products. Their function is to duplicate local alarms found on the primary equipment and to signal workers in a remote location that there is an alarm condition with their system. They act as a valuable early warning device for the isolated worker and allows him to make a safe egress from a hazardous work environment. Virtually all of our equipment can be outfitted with a remote alarm device.

SPECIFICATIONS

ELECTRIC MODELS ONLY

| | |
|------------------------|--|
| Power Required: | 8 -12 Volts DC |
| Weight: | 2 - 4 lbs |
| Cable: | 50 ft. standard (other lengths are available as an option) |
| Connector: | 4 position twist lock |

PNEUMATIC MODEL 50-ALMP

| | |
|---------------------------|---|
| Pressure: | 15 -125psi inlet pressure |
| Horn Set Pressure: | 15psi |
| Weight: | 2 lbs |
| Connector: | 1/8" plug (snaps into socket on primary device) |

SETUP PROCEDURE

- 1.) Test batteries and replace if necessary. (Models 50-ALMST and 50-ALMSTH only).
- 2.) Attach connector on the end of the remote alarm cable or hose to the mating connector found on the primary device. *Note: Primary device refers to the product you will be connecting the remote alarm to.*

OPERATION FOR MODELS 50-ALM, 50-ALMH, 50-ALMST, 50-ALMSTH, 50-ST

- 1.) If the remote alarm is connected to a device that monitors for CO (carbon monoxide), locate the on/off/test switch on the right endplate of the CO monitor. Hold the switch in the test position and check the remote alarm, the audible alarm should be pulsing and the strobe (if installed) should be flashing.
 - 2.) Release the switch to the on position. The unit is now operational.
-
- 1A.) If the remote alarm is connected to a device that signals a loss of pressure, locate the low pressure alarm on/off switch and flip it to the on position. The audible alarm should be pulsing and the strobe (if installed) should be flashing. *Note: Pressure must be below 500psi on high pressure units or below 50psi on low pressure units for the alarms to activate.*

The unit is now operational.

OPERATION FOR MODELS 50-ALMAA & 50-ALMSTAA

- 1.) These remote alarms should be used with “Auto-Air” devices. Locate the on/off/test switch located on the right endplate of the CO monitor. Hold the switch in the test position and check the remote alarm. One audible alarm should be producing a constant tone. Release the on/off/test switch and located the backup air alarm on/off switch on the left endplate of the monitor. Flip the switch to the on position and check the remote alarm. One alarm should be pulsing and the strobe (if installed) should be flashing. *Note: Primary air must be disconnected from the “Auto-Air” device or be below 50psi for the backup alarms to activate.*

The unit is now operational.

OPERATION FOR MODEL 50-ALMP

- 1.) Turn the regulator knob in the remote alarm box fully counterclockwise.
- 2.) Pressurize the primary device.
- 3.) Set primary device in alarm mode. This could be high CO, backup air, or low pressure.
- 4.) Turn regulator knob in remote alarm box clockwise until horn reaches desired sound level (15psi is usually sufficient).
- 5.) Reset the primary device to normal operation. The unit is now operational.

TROUBLESHOOTING

PROBLEM

Remote alarm doesn't sound but primary alarm operates.

SOLUTION

Check alarm cable jack to see if it is secured tightly to remote alarm jack.

Check to see if fresh batteries are in both the primary unit and remote alarm device (Models 50-ALMST and 50-ALMSTH).

Check to see if wires are properly connected to audible and visual alarms.

Bottled air units must have low pressure, usually below 600 psi, to make the alarm activate. On/off switch must be "on".

CO monitor "test" switch must be lifted up to operate alarm.

SETUP/OPERATION FOR MODEL 50-ALM-2J

The 50-ALM-2J remote alarm interface box is designed to accommodate two remote alarms with a single input signal. It requires two 9-volt batteries to operate.

- 1.) Install two (2) 9-volt batteries in the battery pack compartment. Make sure the positive (+) and negative (-) terminals of the batteries are installed properly. Polarity markings are located in the battery drawers (note that they are installed in the inverted position).

Periodically replace the two 9-volt batteries located inside the interface box.

- 2.) Attach the supplied jumper wire to the remote alarm jack located on the Breather Box.
- 3.) Attach the other end of the supplied jumper wire to the 50-ALM-2J box on the incoming connection (see attached drawing).
- 4.) Attach the remote alarms to the remote alarm output jacks.
- 5.) Test the remote alarms by placing the carbon monoxide test on/off switch to the test position.
- 6.) The alarms will sound.

TROUBLESHOOTING

- 1.) If the unit is not functioning at all or has a weak output signal, replace 9-volt batteries.
- 2.) If a particular jack is not functioning, remove the box cover and check for a broken wire or unsoldered connection. See proper wiring schematic attached.

MODEL 50-ALM-2J

CONNECT TO
REMOTE ALARM
JACK ON BREATHER BOX

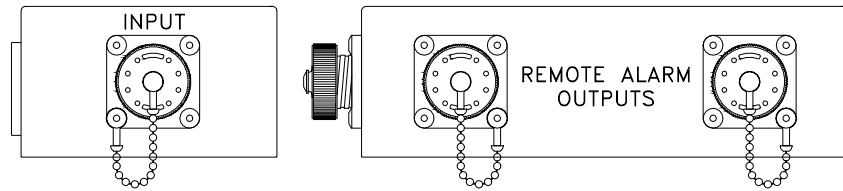
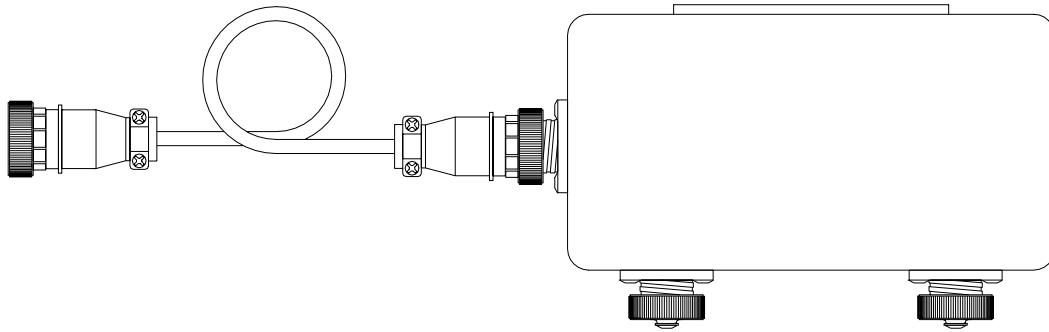

WIRING SCHEMATIC

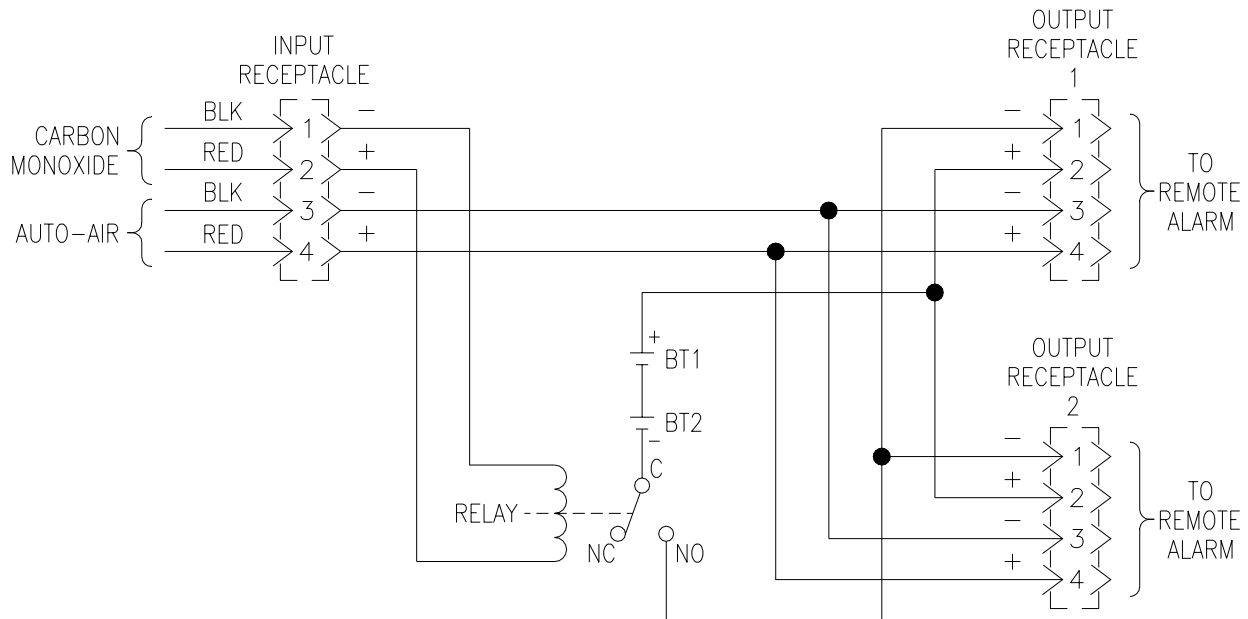

REPLACEMENT ITEMS MODEL 50-ALM

| ITEM # | DESCRIPTION | PART # |
|--------|-----------------|---------|
| 1 | AUDIBLE ALARM | ELLS004 |
| 2 | 4 POSITION PLUG | ELJP003 |
| 3 | 18-2 SJ CABLE | ELCB006 |

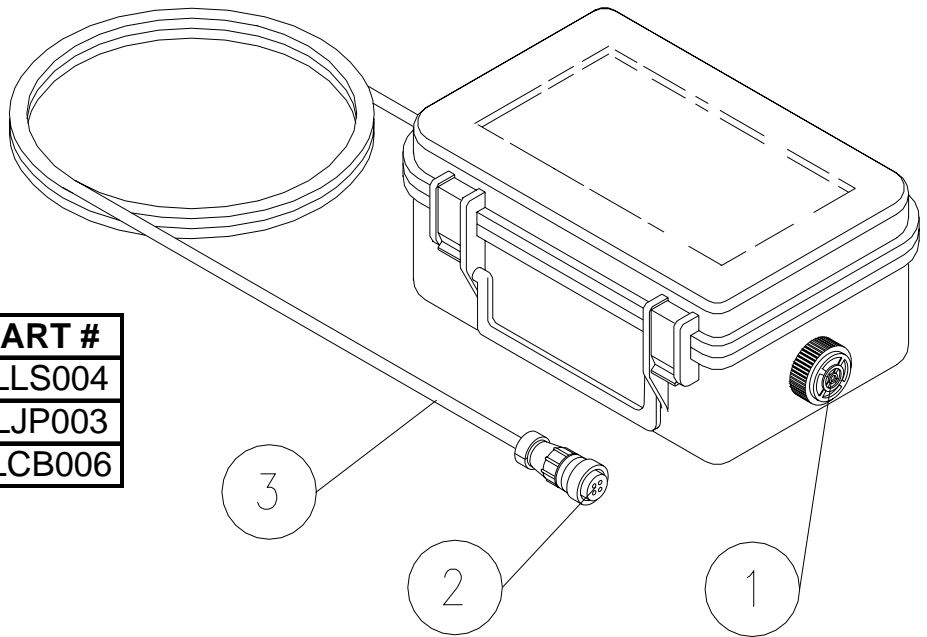

REPLACEMENT ITEMS MODEL 50-ALMAA

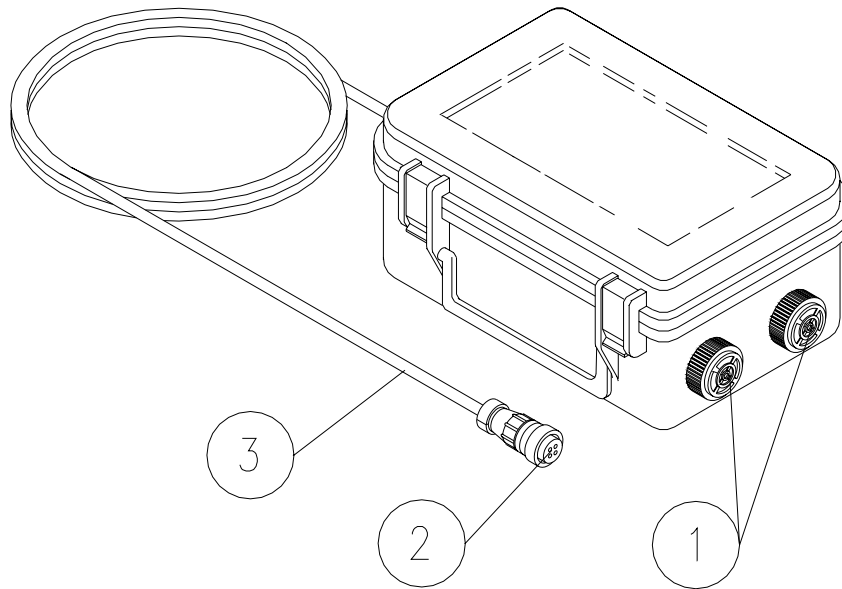

| ITEM # | DESCRIPTION | PART # |
|--------|-----------------|---------|
| 1 | AUDIBLE ALARM | ELLS004 |
| 2 | 4 POSITION PLUG | ELJP003 |
| 3 | 22-4 CABLE | ELCB018 |

REPLACEMENT ITEMS MODEL 50-ALMH

| ITEM # | DESCRIPTION | PART # |
|--------|----------------------|---------|
| 1 | HIGH INTENSITY ALARM | ELLS003 |
| 2 | 4 POSITION PLUG | ELJP003 |
| 3 | 18-2 SJ CABLE | ELCB006 |

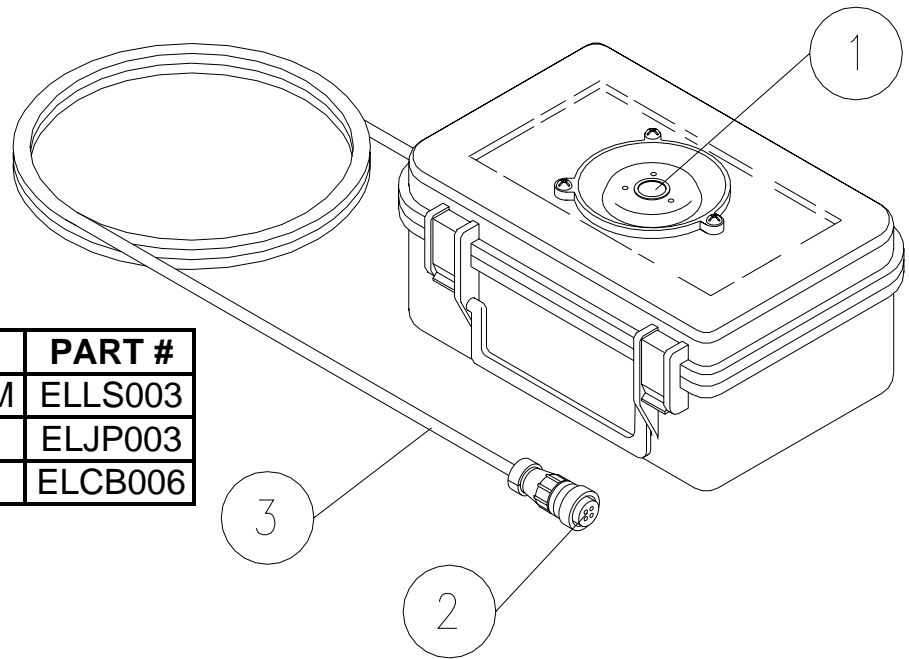

REPLACEMENT ITEMS MODEL 50-ALMSTAA

*Note: Light
activates on
reserve air mode
only*

| ITEM # | DESCRIPTION | PART # |
|--------|---------------------|----------|
| 1 | AUDIBLE ALARM | ELLS004 |
| 2 | 4 POSITION PLUG | ELJP003 |
| 3 | 22-4 CABLE | ELCB018 |
| 4 | STROBE GUARD | ELDS011 |
| 5 | STROBE | ELDS007 |
| 6 | BULB FOR STROBE | ELDS010 |
| 7 | RED LENS FOR STROBE | ELDS010L |

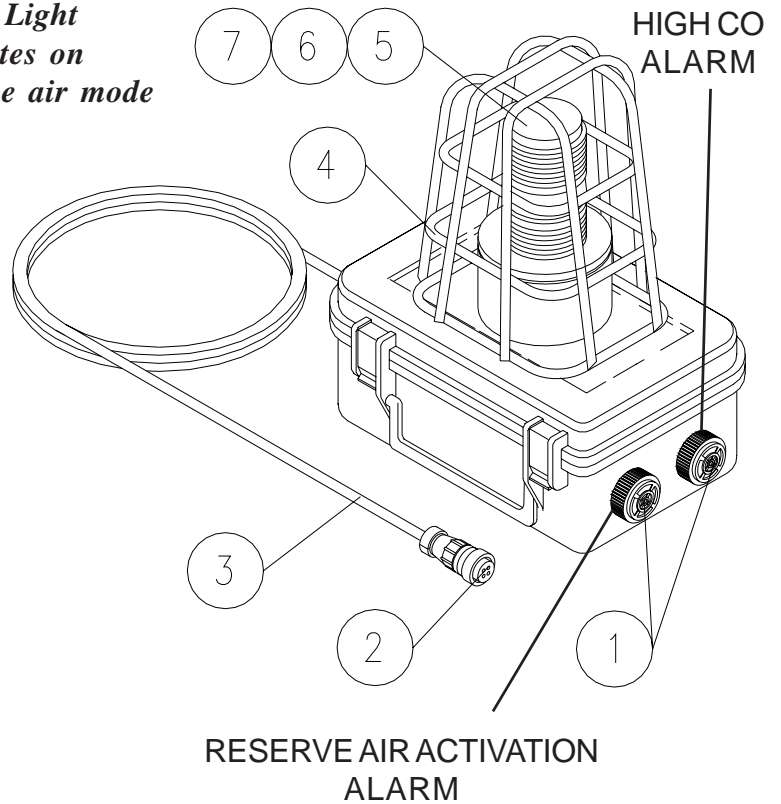

REPLACEMENT ITEMS MODEL 50-ST

| ITEM # | DESCRIPTION | PART # |
|--------|---------------------|----------|
| 1 | 4 POSITION PLUG | ELJP003 |
| 2 | 18-2 SJ CABLE | ELCB006 |
| 3 | STROBE GUARD | ELDS011 |
| 4 | STROBE | ELDS007 |
| 5 | BULB FOR STROBE | ELDS010 |
| 6 | RED LENS FOR STROBE | ELDS010L |

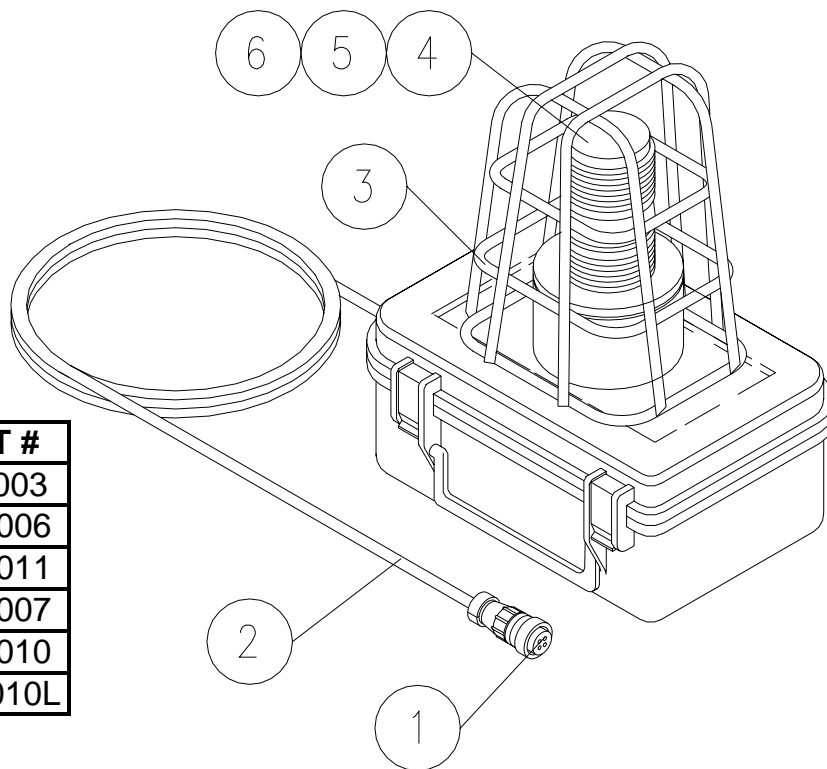

REPLACEMENT ITEMS MODEL 50-ALMP

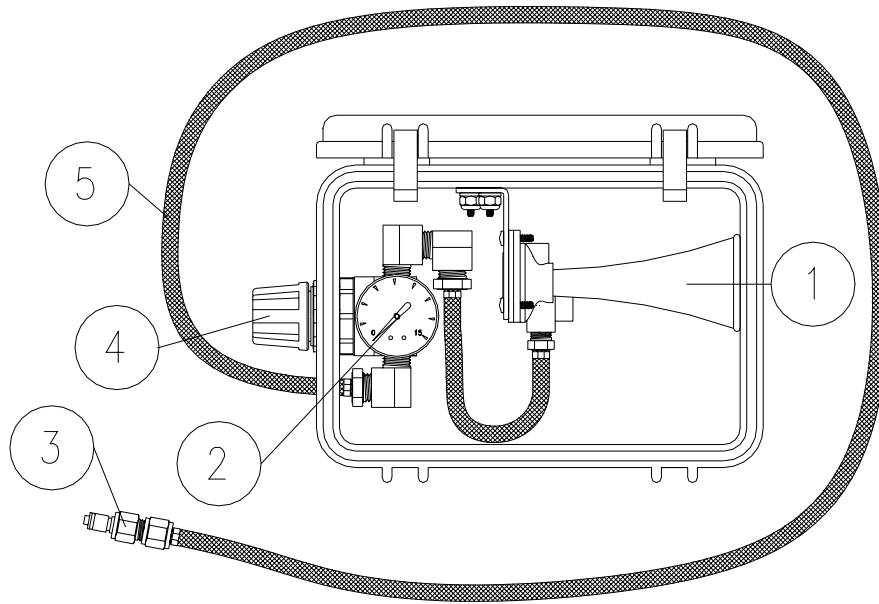

| ITEM # | DESCRIPTION | PART # |
|--------|--------------------|----------|
| 1 | PNEUMATIC HORN | GAMLHORN |
| 2 | PRESSURE GAUGE | GA1515B |
| 3 | INLET PLUG | QDCSL2M |
| 4 | PRESSURE REGULATOR | WL013 |
| 5 | BRAIDED HOSE | HOS004 |

REPLACEMENT ITEMS MODEL 50-ALMST

| ITEM # | DESCRIPTION | PART # |
|--------|------------------------|----------|
| 1 | AUDIBLE ALARM | ELLS004 |
| 2 | 4 POSITION PLUG | ELJP003 |
| 3 | TWIN 9V BATTERY HOLDER | MONC006 |
| 4 | 18-2 SJ CABLE | ELCB006 |
| 5 | STROBE GUARD | ELDS011 |
| 6 | STROBE | ELDS007 |
| 7 | BULB FOR STROBE | ELDS010 |
| 8 | RED LENS FOR STROBE | ELDS010L |

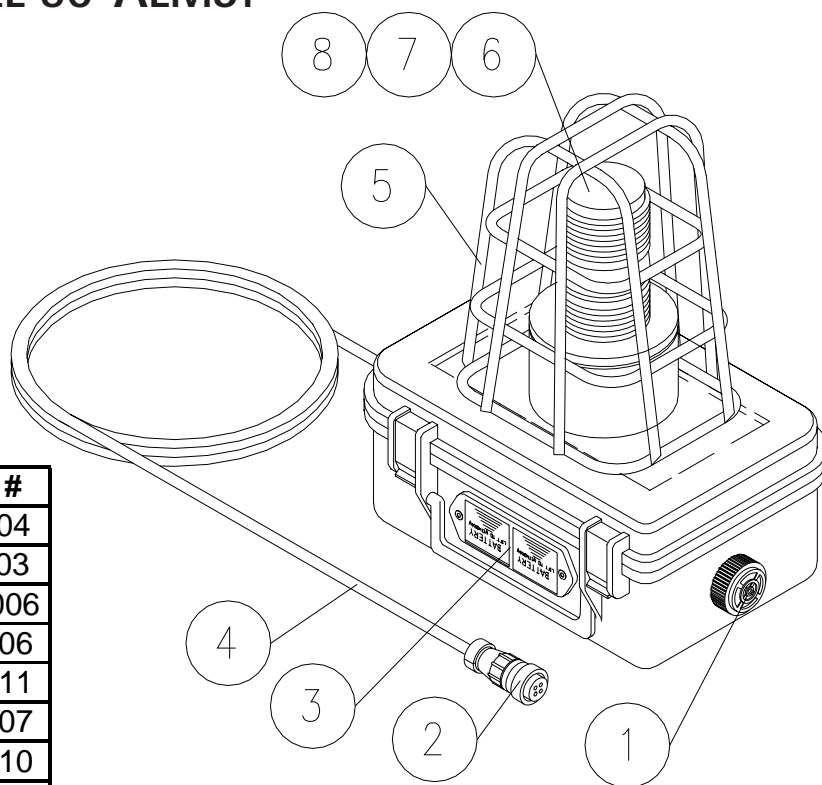

REPLACEMENT ITEMS MODEL 50-ALMSTH

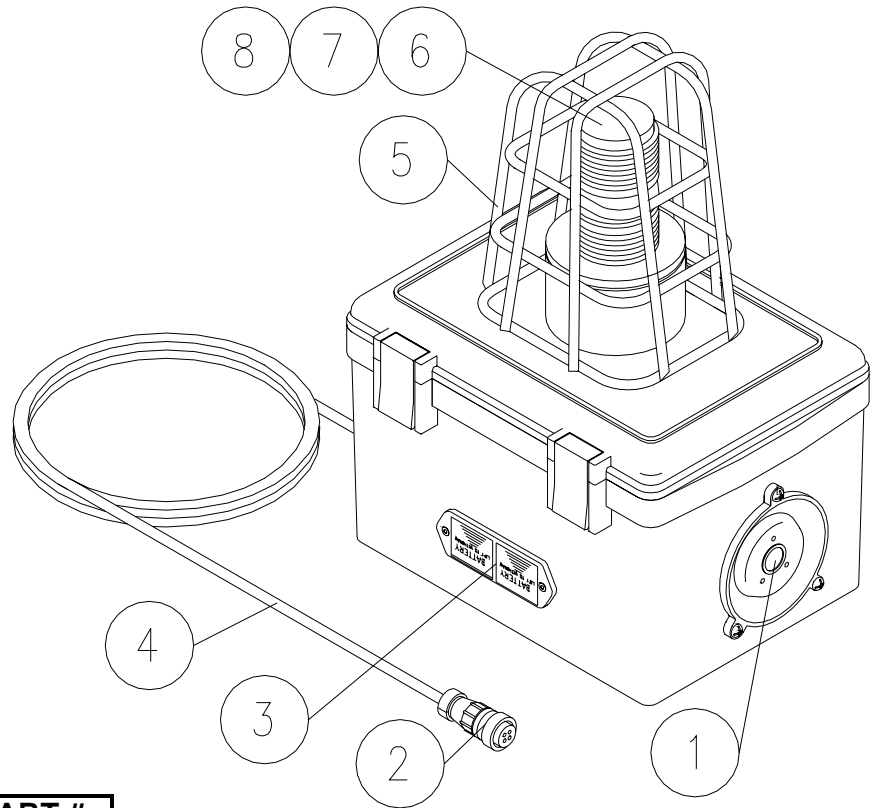

| ITEM # | DESCRIPTION | PART # |
|--------|----------------------|----------|
| 1 | HIGH INTENSITY ALARM | ELLS003 |
| 2 | 4 POSITION PLUG | ELJP003 |
| 3 | TWIN 9V BATTERY PACK | MONC006 |
| 4 | 18-2 SJ CABLE | ELCB006 |
| 5 | STROBE GUARD | ELDS011 |
| 6 | STROBE | ELDS007 |
| 7 | BULB FOR STROBE | ELDS010 |
| 8 | RED LENS FOR STROBE | ELDS010L |

REPLACEMENT ITEMS
MODEL 50ALMSTHAA

| ITEM # | DESCRIPTION | PART # |
|--------|----------------------|----------|
| 1 | HIGH INTENSITY ALARM | ELLS003 |
| 2 | 4 POSITION PLUG | ELJP003 |
| 3 | 22-4 CABLE | ELCB018 |
| 4 | STROBE GUARD | ELDS011 |
| 5 | STROBE | ELDS007 |
| 6 | BULB FOR STROBE | ELDS010 |
| 7 | RED LENS FOR STROBE | ELDS010L |

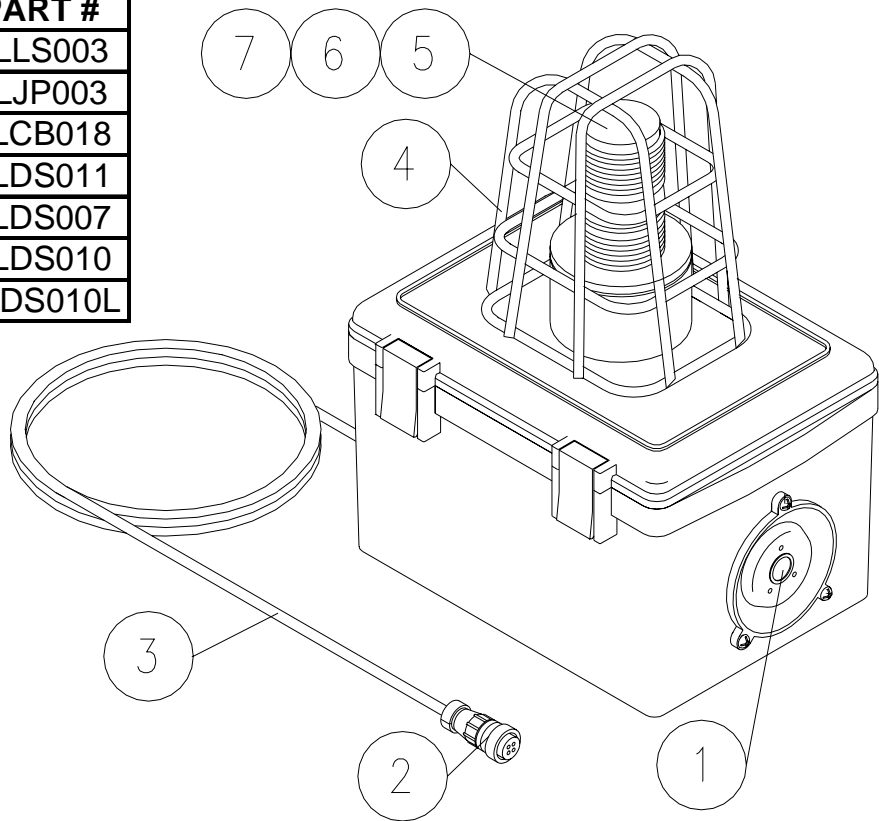

Warranty Disclaimer

Air Systems' manufactured equipment is warranted to the original user against defects in workmanship or materials under normal use for one year after date of purchase. Any part which is determined by Air Systems to be defective in material or workmanship will be, as the exclusive remedy, repaired or replaced at Air Systems' option. This warranty does not apply to electrical systems or electronic components. Electrical parts are warranted, to the original user, for 90 days from the date of sale. During the warranty period, electrical components will be repaired or replaced at Air Systems' option.

NO OTHER WARRANTY, EXPRESSED OR IMPLIED, AS TO DESCRIPTION, QUALITY, MERCHANTABILITY, FITNESS FOR A PARTICULAR PURPOSE, OR ANY OTHER MATTER IS GIVEN BY AIR SYSTEMS IN CONNECTION HEREWITH. UNDER NO CIRCUMSTANCES SHALL THE SELLER BE LIABLE FOR LOSS OF PROFITS, ANY OTHER DIRECT OR INDIRECT COSTS, EXPENSES, LOSSES OR DAMAGES ARISING OUT OF DEFECTS IN, OR FAILURE OF THE PRODUCT OR ANY PART THEREOF.

The purchaser shall be solely responsible for compliance with all applicable Federal, State and Local OSHA and/or MSHA requirements. Although Air Systems International believes that its products, if operated and maintained as shipped from the factory and in accordance with our "operations manual", conform to OSHA and/or MSHA requirements, there are no implied or expressed warranties of such compliance extending beyond the limited warranty described herein. Product designs and specifications are subject to change without notice. **Rev 2 12/98**

Air leaks are not covered under warranty except when they result from a defective system component, i.e. an on/off valve or regulator or upon initial delivery due to poor workmanship. Air leaks due to poor delivery or damage will be covered under delivery claims. Minor air leaks are part of routine service and maintenance and are the responsibility of the customer just as are filters and oil changes.