

SECUNORM 300

THE PERFECT FORM FOR SAFE CUTTING.

NEW



THE SAFER WAY TO CUT.

martor

SECUNORM 300

NO. 30000110



Original size



Ergonomic handle

The excellent ergonomics can be felt all over the SECUNORM 300, for example in the newly shaped handle which fits comfortably into the hand. Or in details such as the nicely rounded knife end or the non-slip soft grip on the slider.



Pleasantly light

Like its predecessor, the SECUNORM 300 also impresses with its lightness. For just 52 grams you get a comfortable and versatile professional cutting tool.



Abrasion resistant

The SECUNORM 300 is made of a glass fibre reinforced plastic, making it particularly abrasion resistant. Your safety knife therefore stays in top form even when in heavy contact with the cutting material.



Increased cutting depth

The increased cutting depth further expands the range of applications. Even frequent cutting is easy – another benefit of the new design with its outstanding ergonomics.

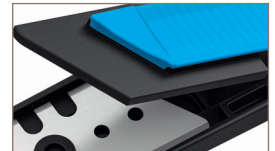

Optimal blade changing

Just pressing the blade change button allows you to remove the plastic insert with the blade. The click-in blade cover and integrated magnet make blade changing even easier and safer.

Surprisingly light. Convincingly good.

With rounded-tip trapezoid blade.



The SECUNORM 300 is the SECUNORM 500's "little brother" and a further development of the SECUNORM PROFI LIGHT. It retains a pleasant lightness as well as the proven automatic blade retraction. You'll discover much more in the optimised SECUNORM 300 all-rounder. For example, the especially ergonomic design, an increased cutting depth, the new soft grip, and extremely user-friendly blade changing.

PRODUCT FEATURES

Technical features

| | |
|---|--|
|  High safety |  Safer blade change (with magnet) |
|  Abrasion resistant |  Very ergonomic |
|  2-cutting edge blade |  Cutting depth |
|  Rounded-tip trapezoid blade |  Ceramic blade insertable |
|  Soft grip |  For right and left handers |

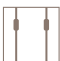





Main cutting materials

| | |
|---|---|
|  Cardboard: up to 3-ply |  Wrapping, stretch and shrink foil |
|  Plastic strapping band |  Tape |
|  Bagged goods |  Layers of foil or paper |

Installed blade

| | |
|--|--|
|  | NO. 65232 0.63 mm, rounded blade tips, deep-edged |
|--|--|

Optional blade

| | |
|--|--|
|  | NO. 65232C 0.65 mm, ceramic, rounded blade tips, deep-edged |
|  | NO. 5232 0.63 mm, deep-edged |
|  | NO. 5233 0.63 mm, 1-sided ground-edge |
|  | NO. 610 0.63 mm, stainless |
|  | NO. 852 0.63 mm, stainless, TiN |
|  | NO. 56 0.63 mm |
|  | NO. 5634 0.63 mm, rounded blade tips |

Certificates and awards



Application

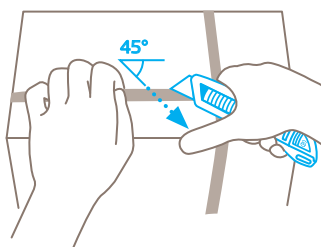
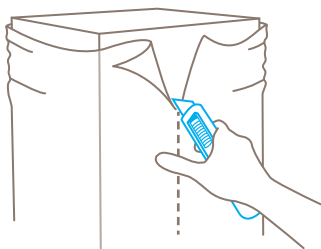
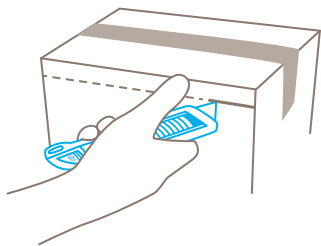

Safety technology

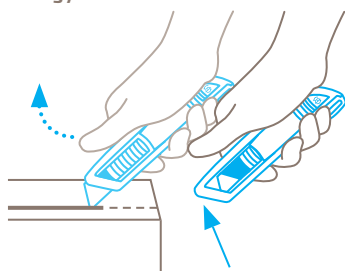

Automatic blade retraction – a high degree of safety

The automatic blade retraction of the SECUNORM 300 guarantees a high degree of safety from cut injuries. As soon as you have started to cut, take your thumb off the slider. Then the blade will retract into the handle immediately after leaving the material being cut.

YOU CAN FEEL THE QUALITY.





SECUNORM 300

- › For high cutting frequencies
- › Light ergonomic handle for left and right handers
- › Made of abrasion resistant plastic
- › Automatic blade retraction
- › GS-certified for approved safety

PRODUCT DETAILS

| | |
|--|--|
| Order No. | NO. 30000110.02 |
| Packaging unit | 1 in single unit box (10 pieces in multipack) |
| Knife size (L x W x H) | 143 x 16 x 36 mm |
| Main material | Glass fibre reinforced plastic |
| Weight | 52.0 g |
| Cutting depth | 17 mm |
| Spare blade Packaging unit Size (L x W x Thickness) | NO. 65232.70 (10 in dispenser) 50.1 x 19 x 0.63 mm |
| Certified | GS certificate NO. 178531-7034-55094-2019/1 |

Accessories

| | | |
|--|---|------------|
| BELT HOLSTER S WITH CLIP |  | NO. 9920 |
| HOLSTER SMALL |  | NO. 9842 |
| USED BLADE CONTAINER |  | NO. 9810 |
| WALL MOUNT BRACKET USED BLADE CONTAINER |  | NO. 9845 |
| SAFEBOX |  | NO. 108000 |

CONTACT AND SERVICE

What makes our cutting solutions even safer? Our advisory services! We are always on hand, to give advice, to provide you with training material, to meet with you in person if necessary.

You will find further information on our website: www.martor.com



At a glance: the safety poster shows the most important functions and correct usage – perfect for your workplace.



From the first cut to changing the blade, our video will show you the best way to use this knife.



Everything you want to know: dimensions, properties, special features and more about our cutting tools can be found in the technical data sheet.



Still have questions? You can reach our service department on [+49 212 73870-0](tel:+49212738700)