

SECUMAX 350

ROBUST, COMFORTABLE, SAFE? VERY SAFE!

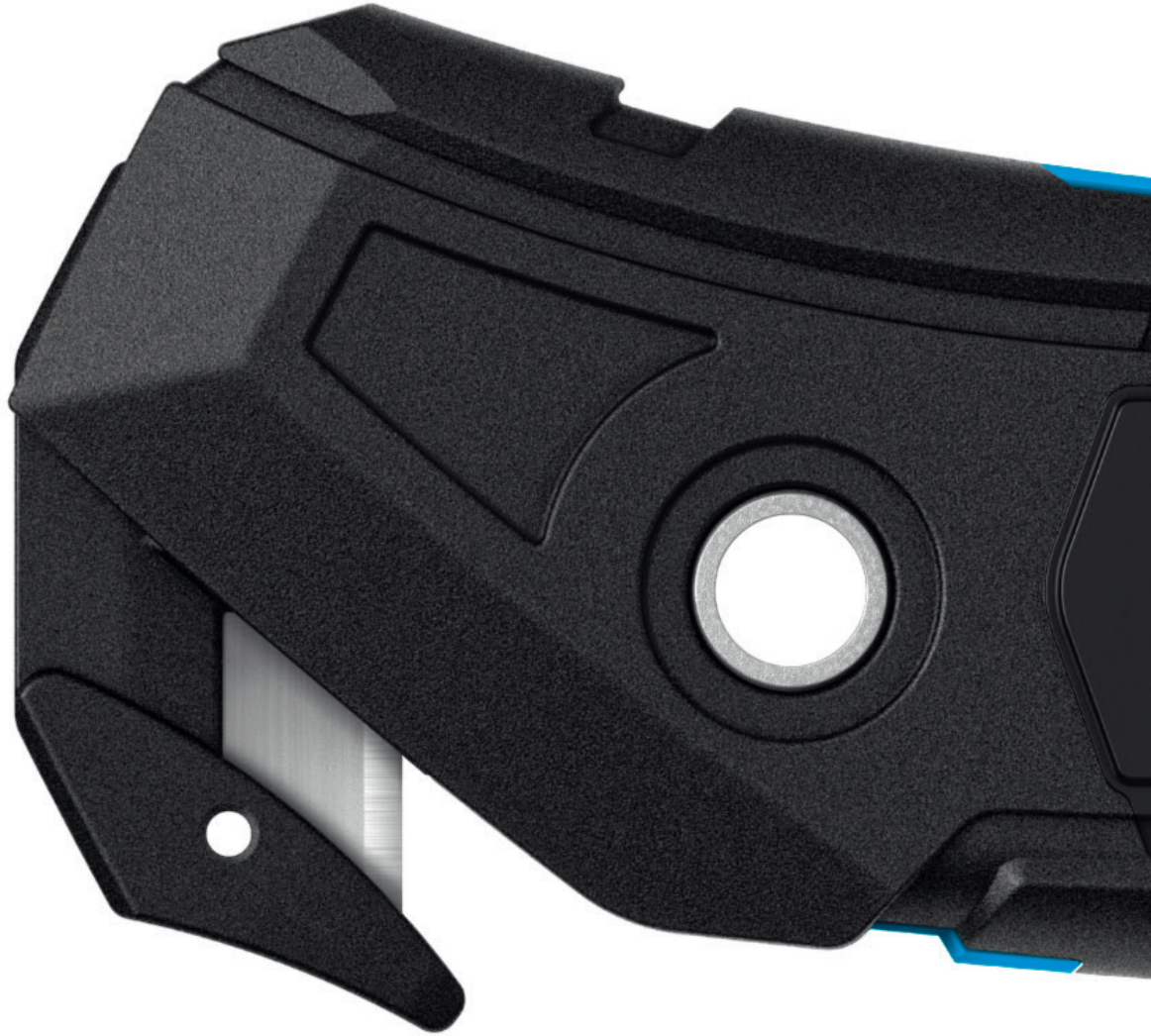

THE SAFER WAY TO CUT.

martor

SECUMAX 350

NO. 350005



Original size



Robust blade head

The plastic-covered blade head is particularly robust with a blade thickness of 0.5 mm. This SECUMAX 350 can therefore take on especially difficult cutting materials in logistics and production.



Concealed blade

The blade head's two cutting edges are safely concealed to protect users and goods and are yet capable of safely cutting 2-ply cardboard boxes and much more.



Spare blade in storage

Blade change is easily and safely executed. Look for the arrow and follow its lead. Open the blue inner side of the knife to reveal the spare blade while also releasing the locking mechanism of the robust blade head.



Light and easy

A cutting heavyweight, but with only 38 grams, this knife is rather lightweight. Meaning that even high cutting frequencies won't weigh you down. There's no need to stress when handling the blade either: a plastic jacket protects your fingers.



Ergonomically shaped

Right handed or left handed? It's really all the same. The SECUMAX 350 fits perfectly in any hand. Gently arched outer edges, coupled with suitably located soft grip and light ribbing make for an ergonomic experience.

More fun while you work? Try it out.

With robust blade head.







Comfort, strength and maximum safety go hand in hand in the SECUMAX 350 with its robust blade head. The versatile SECUMAX 350 is a true all-rounder with an innovative blade change system. It can be used for standard cutting materials as well as for more difficult cuts such as thicker film and strapping band. And it feels so good you won't want to put it down.

PRODUCT FEATURES

Technical features

-  Maximum safety
-  Tool-less blade change
-  Abrasion resistant
-  Very ergonomic
-  2-cutting edge blade
-  1 spare blade in knife body
-  Cutting depth
-  Soft grip
-  For right and left handers
-  Lanyard hole
-  Printable for promotional purposes

Main cutting materials

-  Cardboard: up to 2-ply
-  Wrapping, stretch and shrink foil
-  Tape
-  Plastic strapping band
-  Bagged goods
-  Layers of foil or paper

Installed blade



Optional blade



Certificates and awards



Application

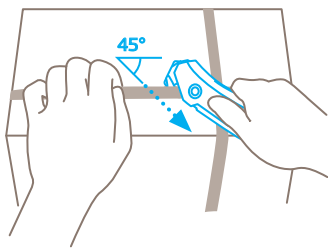
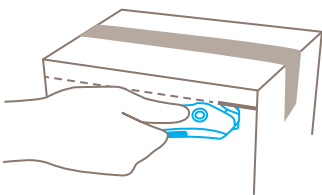
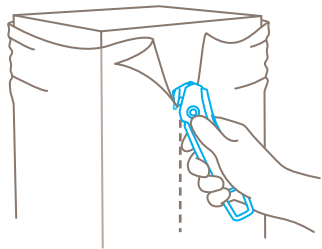

Safety technology

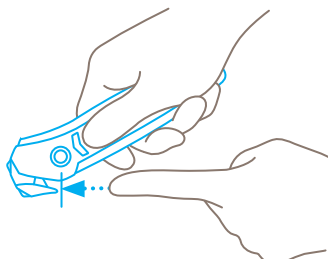

Concealed blade – a maximum degree of safety

The SECUMAX 350 blade is not an open one, but is hidden from people and goods. This provides you with a maximum degree of safety from cut injuries and from damage to goods.

YOU CAN FEEL THE QUALITY.





SECUMAX 350

- › Robust blade head
- › Concealed blade
- › Spare blade in storage
- › Ergonomic shape including soft grip
- › GS-certified for approved safety

PRODUCT DETAILS

Order No.	NO. 350005.02
Packaging unit	1 in single unit box (10 in multipack)
Knife size (L x W x H)	152 x 12 x 40 mm
Main material	Glass fibre reinforced plastic
Weight	38.0 g
Cutting depth	6 mm
Spare blade Packaging unit Size (L x W x Thickness)	NO. 3448.20 (10 in box) 38.9 x 23.7 x 0.50 mm
Certified	GS certificate NO. S 60131131

Accessories

BELT HOLSTER S WITH CLIP		NO. 9920
CONNECTOR		NO. 9946
USED BLADE CONTAINER		NO. 9810
WALL MOUNT BRACKET USED BLADE CONTAINER		NO. 9845

CONTACT AND SERVICE

What makes our cutting solutions even safer? Our advisory services! We are always on hand, to give advice, to provide you with training material, to meet with you in person if necessary.

You will find further information on our website:
www.martor.com



At a glance: the safety poster shows the most important functions and correct usage – perfect for your workplace.



From the first cut to changing the blade, our video will show you the best way to use this knife.



Everything you want to know: dimensions, properties, special features and more about our cutting tools can be found in the technical data sheet.



Still have questions? You can reach our service department on **+49 212 73870-0**